



CLYDE MARINE SERVICES LTD



PASSENGER VESSEL 250 passengers up to 5 miles offshore CLYDE CLIPPER

GENERAL

DELIVERY DATE 2010
 BASIC FUNCTIONS Passenger Vessel
 CLASSIFICATION EU Class C Passenger Certificate for up to 250 persons
 MCA Workboat Category 2

Bureau Veritas : I ✕ HULL • MACH
 Special service / Passenger Carrier
 Coastal area

DIMENSIONS

LENGTH O.A. 27.0 m
 BEAM O.A. 11.20 m
 DEPTH 3.90 m
 DRAUGHT AFT 2.20 m
 DISPLACEMENT 170 Te.
 GRT 125

TANK CAPACITIES

FUEL OIL 15241 litres (12.80 Te)
 FRESH WATER 4446 litres (4.4 Te)

PERFORMANCES

SPEED 12.7 knots

PROPULSION SYSTEM

MAIN ENGINES 2 X Doosan
 TOTAL POWER 806 KW (1080 bhp)
 PROPELLERS 2 X fixed pitch propellers

ACCOMMODATION

The vessel is certified to transport 250 persons and is equipped with a galley and toilet facilities to DDA standard

NAUTICAL AND COMMUNICATION EQUIPMENT

RADAR SYSTEM JRC-5104
 COMPASS Lilley & Gillie
 VHF Icom IC-M411 (DSC)
 Sailor RT2048
 3 x Icom IC-M31 handhelds
 CHART PLOTTER Standard Horizon - GPS Chart CP300
 SEARCHLIGHT Seematz WH80
 GPS equipped JRC J-NAV 500
 AIS equipped Simrad A150
 Horn Ibuki Kogyo Co Ltd - ES300

GENERATOR

2 x Beta Marine 34kw



CLYDE MARINE SERVICES LTD

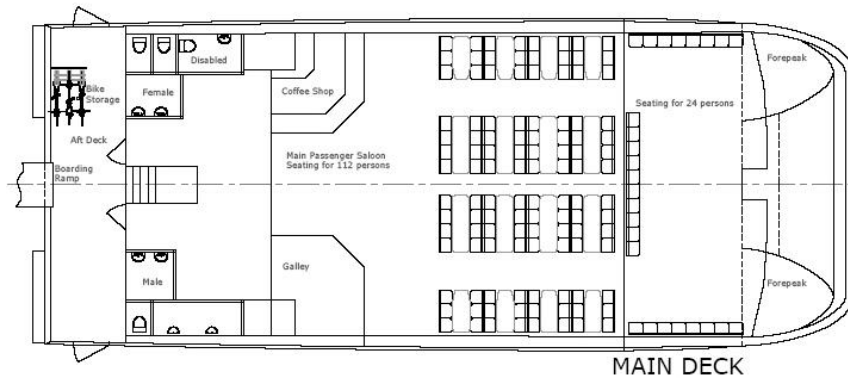
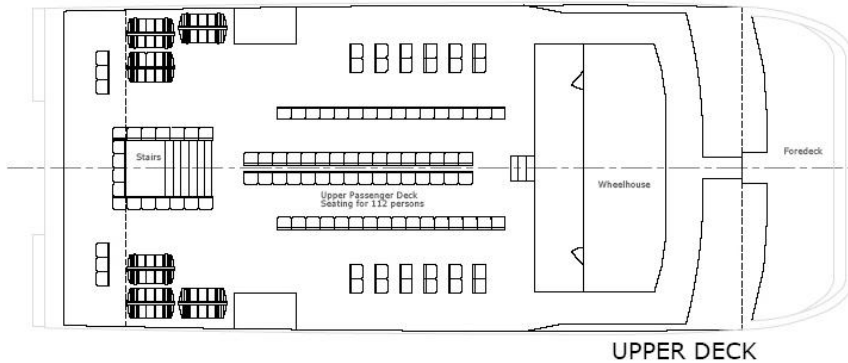
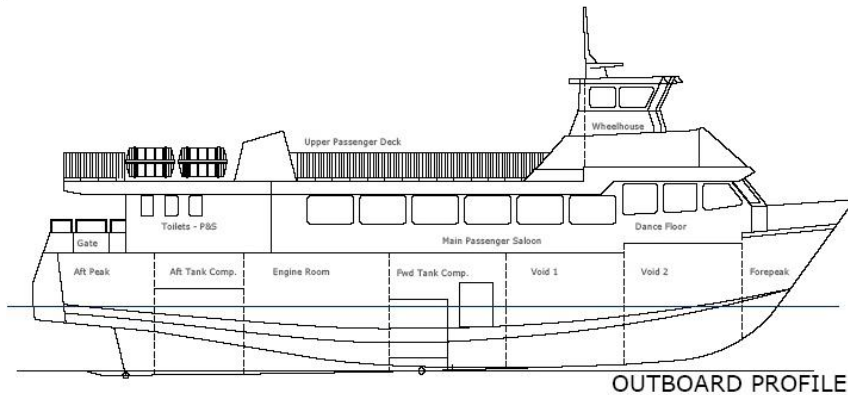

CONTACT DETAILS

CLYDE MARINE SERVICES LTD

Victoria Harbour,
GREENOCK,
PA15 1HW
SCOTLAND

Tel: 01475 721281

Fax: 01475 888023

Email: hamish.munro@clyde-marine.co.uk

www.clyde-marine.co.uk